





Beechfield, Hoddesdon, EN11 9QG

Westwood Leber are delighted to bring to the market this well presented three double bedroom semi-detached family home located on the highly sought after Hundred Acre development. This property has been tastefully updated and extended by the current owners and boasts a wealth of desired features such as a large kitchen/dining room with double doors opening onto a well landscaped and secluded rear garden, a downstairs utility room and w/c, and separate annexe with side access and separate shower room. Further benefits include off-street parking to the front and side access. An internal viewing is highly recommended!



Ground Floor

Approx. 64.4 sq. metres (693.5 sq. feet)



First Floor

Approx. 38.9 sq. metres (418.8 sq. feet)

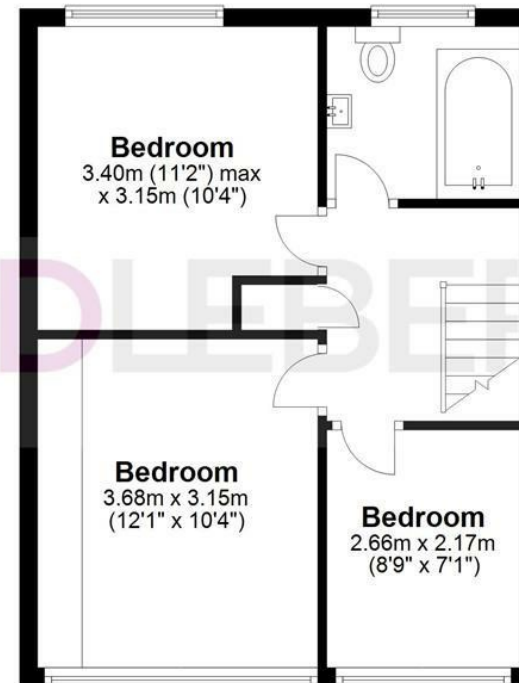

Total area: approx. 103.3 sq. metres (1112.3 sq. feet)

FOR ILLUSTRATIVE PURPOSES ONLY. NOT TO SCALE. Whilst every attempt had been made to ensure the accuracy of the floor plan shown, all measurements, positioning, fixtures, features, fittings and any other data shown are an approximate interpretation for illustrative purposes only and are not to scale. No responsibility is taken for any error, omission, miss-statement or use of data shown. Property marketing provided by Westwood Leber. Plan produced using PlanUp.







